

Deck Plates

- High tensile C1045.
- Self colour finish
- Based upon the Admiralty Pattern.
- W.L.L dependant on current welding procedures being carried out.
- Marked with CE, size, proof load and ID mark.

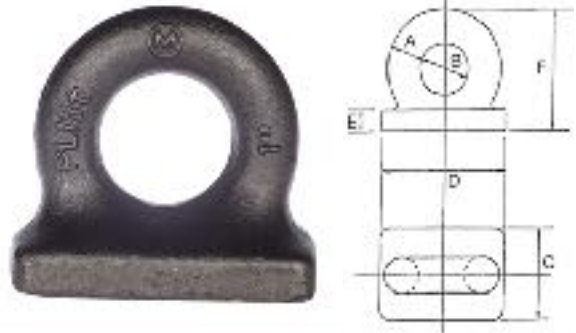

Proof Load (tonnes)	A	B	C	D	E	F	Weight (kgs)
2	3/8" (10mm)	20	25	45	6	38	0.14
3.5	1/2" (12.5mm)	25	35	60	8	50	0.31
5.5	5/8" (16mm)	32	45	70	10	64	0.45
7.5	3/4" (19mm)	33	50	85	12	76	0.79
9.6	7/8" (22mm)	44	61	102	12	88	1.36
13	1" (25mm)	50	70	115	16	100	1.82
15.75	1.1/8" (28mm)	56	76	130	18	114	2.95
20	1.1/4" (32mm)	64	85	145	19	128	3.86
29	1.1/2" (38mm)	76	100	170	22	152	6.58
38.25	1.3/4" (44mm)	89	121	200	27	178	18
50	2" (50mm)	102	137	229	30	203	25